

Field & Clarkson Architects

601-614 WHEAT BUILDING
FORT WORTH, TEXAS

June 22, 1916.

Prof. M. B. Jumper,
Eufaula, Ok.

Dear Sir:--

The writer in taking notes necessary to complete plans for the East Side school building overlooked several items and as you were kind enough to offer your services in obtaining any further information we needed we ask that you kindly obtain the following for us:--

a Exact height of rear (North) outside doors of East Side school. b Exact width of transom bar from offset where door fits to bottom of transom above. c Is the transom above the rear door square or circular. d In either case give us the exact height of the transom **from** the bottom to top.

e The front elevation you gave us shows the two downspouts in the front. Please give us the approximate **location** of downspouts on the other sides of the building and number in all.

We trust this will not be of any trouble and thank you in advance for your kindness. The plans are being worked on by two men and we hope to have them out early next week.

With kind personal regards and thanking you for the courtesy shown the writer while in your little city, we are,

Very truly yours,

Field & Clarkson.

S. of ante
5' between
downspouts

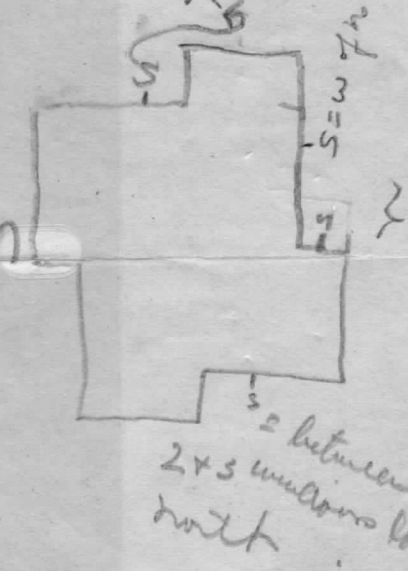

a = 7 ft 9 1/2 in
b = 5 inches
c = semi-circular
d = 9 ft 5 1/2 in

c